

Island Hopper

INSTRUCTION MANUAL



14+
yrs
w/ Adult Supervision

ARF
ALMOST-READY-TO-FLY

3CH/ 4CH Electric R/C Aircraft



**PRECAUCIÓN:
FUNCIONA CON
ELECTRICIDAD.**

No recomendado para niños menores de 14 años. Al funcionar con electricidad, deben cumplirse los consejos de seguridad durante la manipulación y la utilización para evitar posibles descargas eléctricas. Se requiere la supervisión del adulto.

ENTRADA:
120V AC 60 Hz 35mA
SOLAMENTE
SALIDA:
9.6V DC 300mA

**CAUTION:
ELECTRIC TOY.**

Not recommended for children under 14 years of age. As with all electric products, precautions should be observed during handling and use to prevent electric shock. Adult supervision is required.

INPUT:
120V AC 60 Hz 35mA
OUTPUT:
9.6V DC 300mA

WARNING
CHOKING HAZARD - SMALL PARTS
NOT FOR CHILDREN UNDER 3 YEARS



venom

Island Hopper™

INSTRUCTION MANUAL



I. INTRODUCTION

Venom Island Hopper™ is an exciting, Almost Ready For Flight (ARF) Aircraft, perfect for flying in open areas on any light wind day. The size and stability of the Island Hopper™ makes this model ideal for aerobatics or sport flying. Although the Venom Island Hopper™ is not difficult to operate, we recommend that you read these instructions thoroughly and carefully first.

SPECIFICATIONS:

Model No	VENF-8048/8107
Model Name	Island Hopper™
Wingspan	940mm/ 37 in
Wing Area.....	270 sq in
Fuselage Length	750mm/ 29.5 in
Weight (less batt and electronics).....	440g/ 15.52 oz
Battery	AAA 850mah 9.6v
Radio Controller	3ch/4ch (Island Hopper+)
Servo	2 Servo (3ch), 3 Servo (4ch)

GUARANTEE:

We guarantee the Venom Island Hopper™ to be free of manufacturing faults and material defects at time of purchase. This product has been checked and adjusted individually before leaving the manufacturer. Please contact your local hobby shop for replacement parts and technical support or contact Venom Customer Service at 800-705-0620 or customerservice@venom-group.com.

WARNING! READ BEFORE FLIGHT

The Venom Island Hopper™ is not a toy. It is a precision machine requiring proper assembly and setup to avoid accidents and it is the responsibility of the owner to operate this product in a safe manner as it can cause serious personal injury and damage to property due to carelessness or misuse.

When charging a battery pack, do not overcharge! If batteries get hot during charging, discontinue charging immediately and disconnect the batteries from the charger. Never leave batteries unattended while charging. If you are unsure of how to charge a battery, please contact Venom or seek the advice of your local hobby shop. Never let children charge batteries without adult supervision.

To avoid an out of control model always turn the transmitter on first then connect the battery to the model. When turning off the model, always disconnect the battery first, then turn off the transmitter. If the orders are reversed the model may become uncontrollable and cause serious damage.

If you are in doubt of your ability, we strongly recommend that you seek assistance from experienced radio controlled airplane modelers or join your local model flying club to gain the required knowledge and skill. As the manufacturer and distributor, we assume no liability for the use of this product.

Children under the age of fourteen (14) are strictly prohibited from playing with this electric airplane.

II. TOOLS REQUIRED

The Venom Island Hopper™ requires some minor assembly to get it into the air. For your convenience, we have included a list of tools that will make the job easier.



Nut Driver

5.5mm



Side Cutters

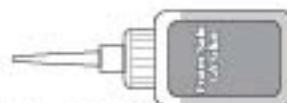

Foam Safe CA Glue



Screwdriver

No.1



Needle Nosed Pliers

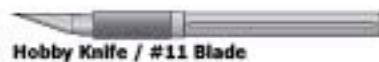

Hobby Knife / #11 Blade



Ruler / Straight Edge



Scissors



Double Sided Tape

Island Hopper

INSTRUCTION MANUAL



III. INCLUDED ITEMS

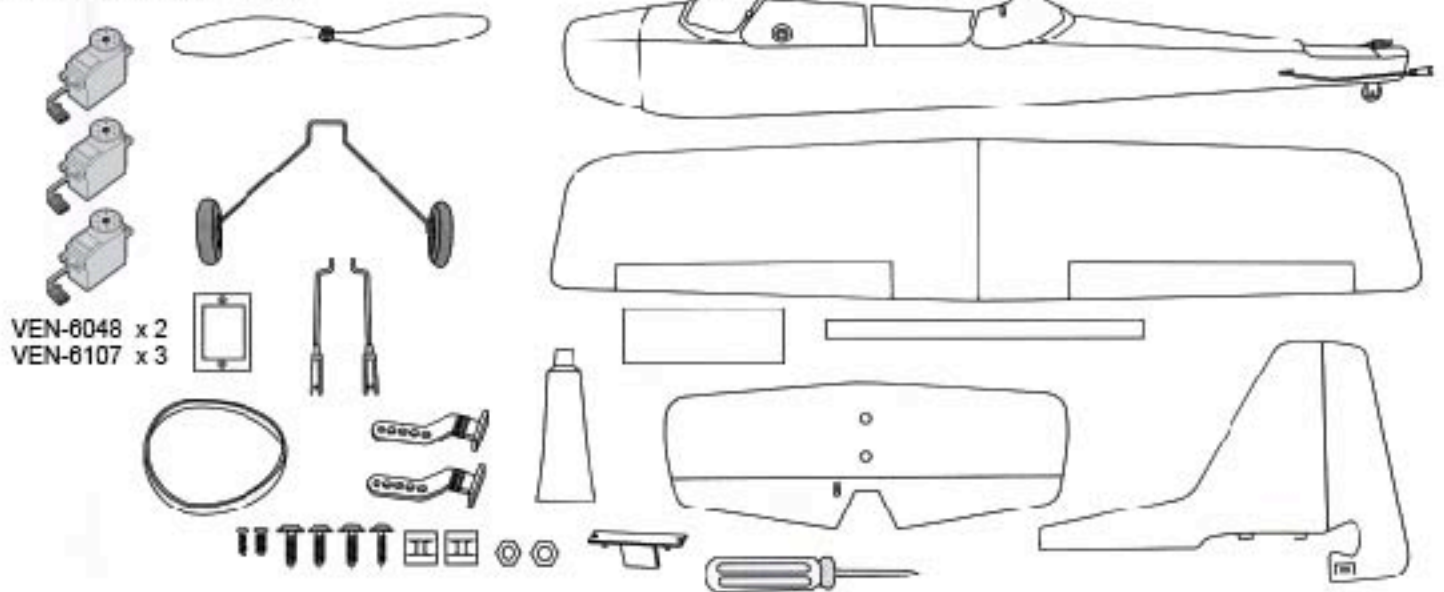

IV. ASSEMBLY



1. Install the landing gear into the slot on the bottom of the fuselage.

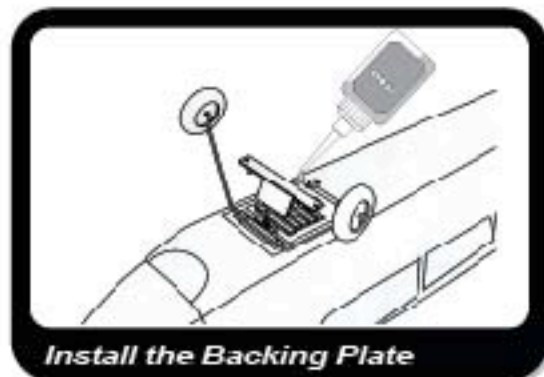

2. Install the landing gear backing plate. Use a small amount of CA to secure in place.

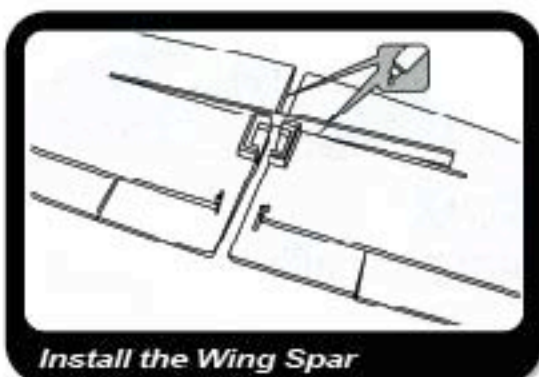

3. Install and glue the wing spar into place using Foam Safe CA.

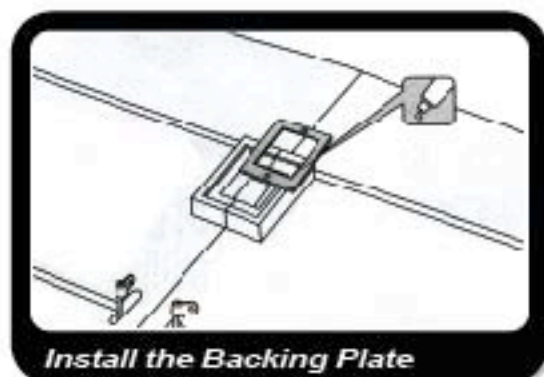

4. Attach the servo plate using a small amount of Foam Safe CA to secure it in place.

Island Hopper

INSTRUCTION MANUAL

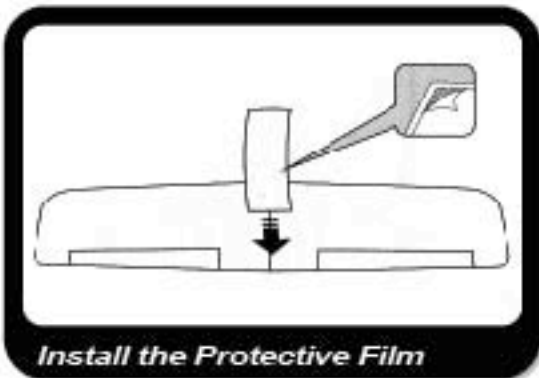

Install the Protective Film

5. Apply the protective film to the center of the wing.

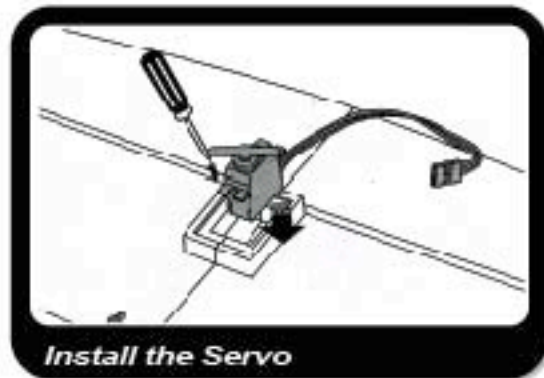

Install the Servo

6. Install the Servo. Note direction.

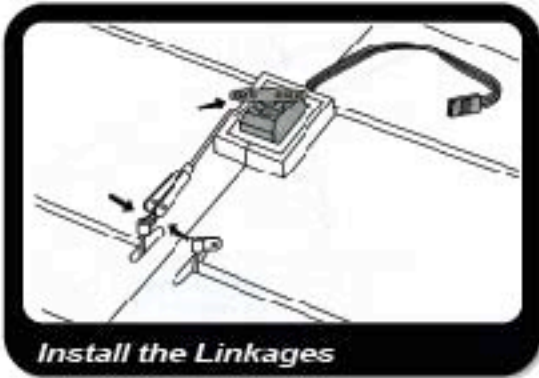

Install the Linkages

7. Install the servo linkages making sure the servo is centered.

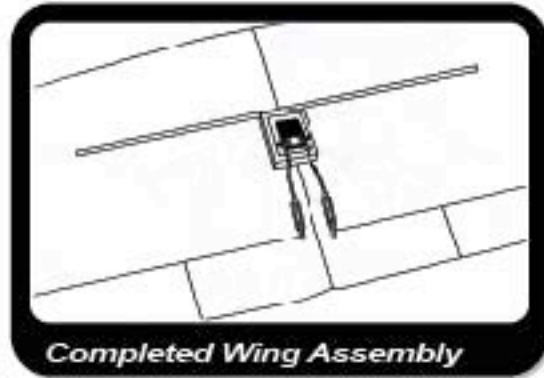

Completed Wing Assembly

8. Finished wing.

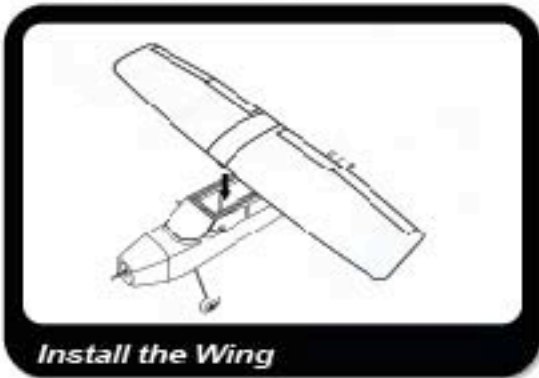

Install the Wing

9. Center the wing to the fuselage and install.

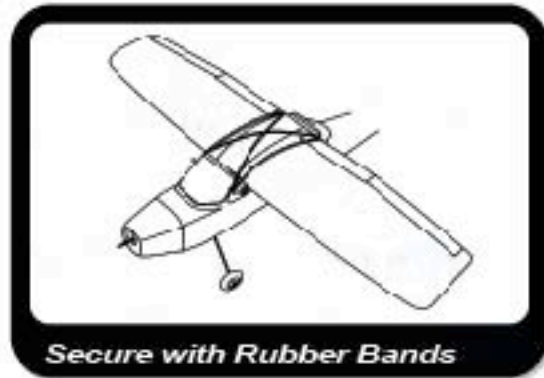

Secure with Rubber Bands

10. Use rubber bands to hold the wing in place.



Horizontal Tail

11. Attach the Horizontal Tail to the fuselage using Foam Safe CA.

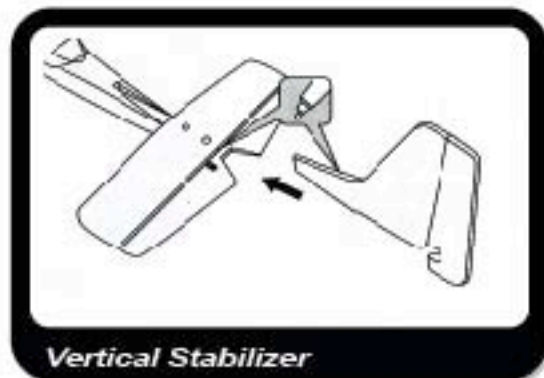

Vertical Stabilizer

12. Attach the Vertical Stabilizer to the fuselage using Foam Safe CA.

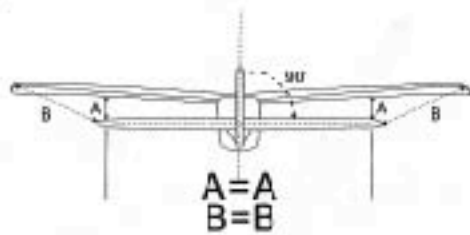

Measure the Surfaces

13. Measure from the center line of the fuselage nose to each stabilizer tip. If the stabilizer is square, the measurements should be equal.

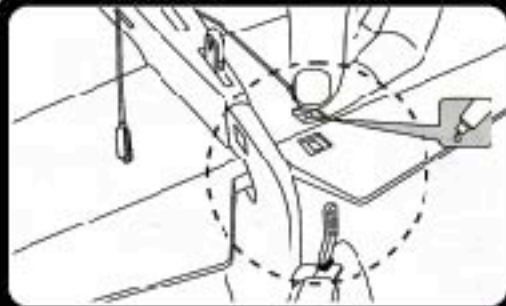

Elevator Linkages

14. Attach the control horns to the elevator with Foam Safe CA.

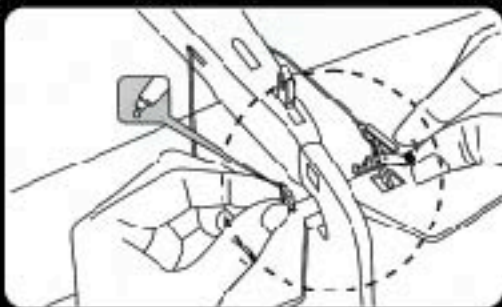

Rudder Linkages

15. Attach the control horns to the rudder with Foam Safe CA.



Completed Linkages

16. Finished linkages.

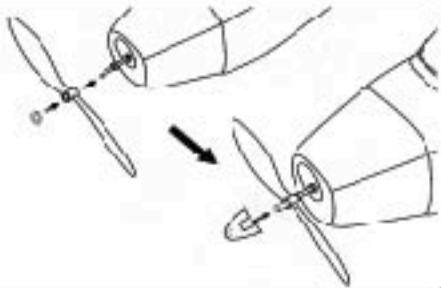

Install the Propeller

17. Install the prop using the prop nut and spinner.



Finished Model

18. Finished model.



V. PREFLIGHT

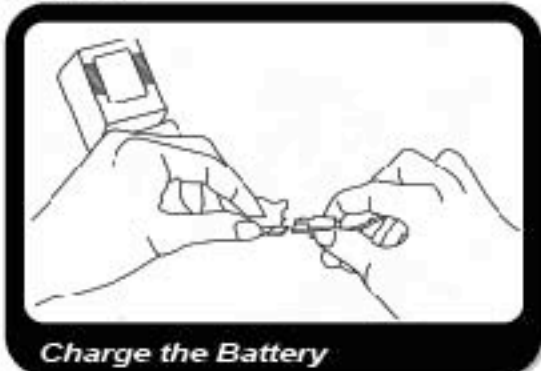

Charge the Battery

1. Charge the battery pack using the kit charger. The battery should be fully charged in 2.5 - 3hrs.



Install the Transmitter Batteries

2. Install 8 AA alkaline batteries into the transmitter and turn on the transmitter.

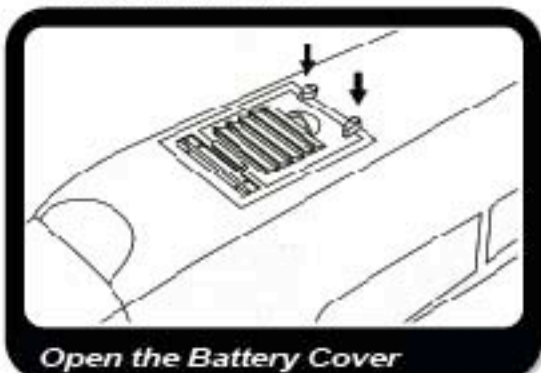

Open the Battery Cover

3. Open the battery cover.

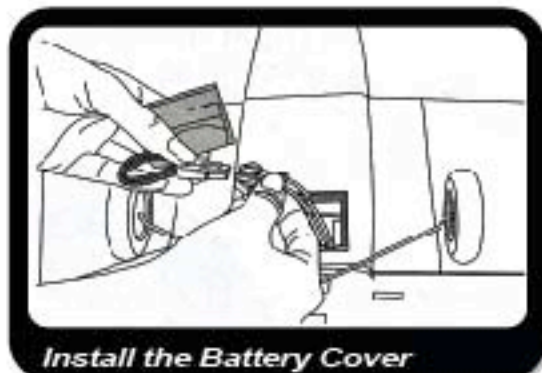

Install the Battery Cover

4. Install the 9.6v Battery pack into the model, connect the battery lead and close the cover.

NOTE!

To avoid an out of control model, the transmitter must always be turned on first and off last! Once the transmitter is on and the battery is plugged in, the control surfaces can be actuated. The motor will not turn until you press the on/off button.

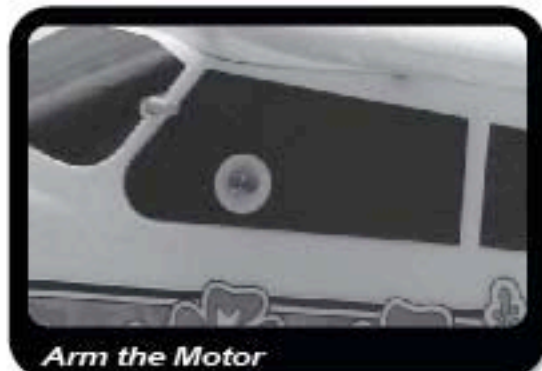

Arm the Motor

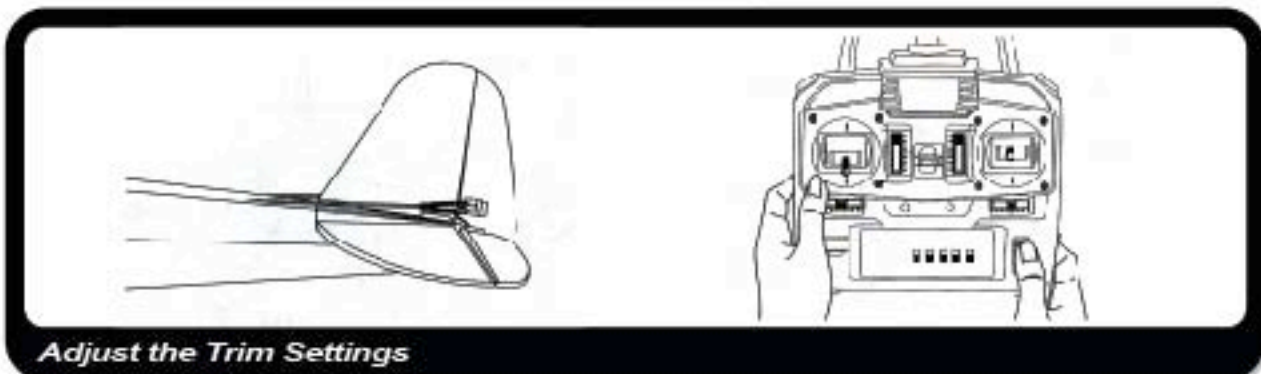

Adjust the Trim Settings

5. Use the trim sliders on the transmitter to adjust the control surfaces. Make sure they are level to avoid erratic flight characteristics. If you cannot get the surfaces level, adjust the length of the linkages and re-attach them to the control horns.

VI. CONTROLS

Checking Control Surface Throws And Radio Operation.

Mode 1 vs. Mode 2

Depending on which region of the world you are in, you will either use a Mode 1 or Mode 2 transmitter. The difference between the two modes deals with the throttle and directional inputs of the control sticks. Mode 2 transmitters are used in North and South America and have the throttle control on the left stick and the directional controls on the right stick. Mode 1 transmitters are used in Europe and Australia and have the inputs reversed with throttle on the right and directional control on the left. The illustrations below detail the stick inputs for both Mode 1 and Mode 2 transmitters.

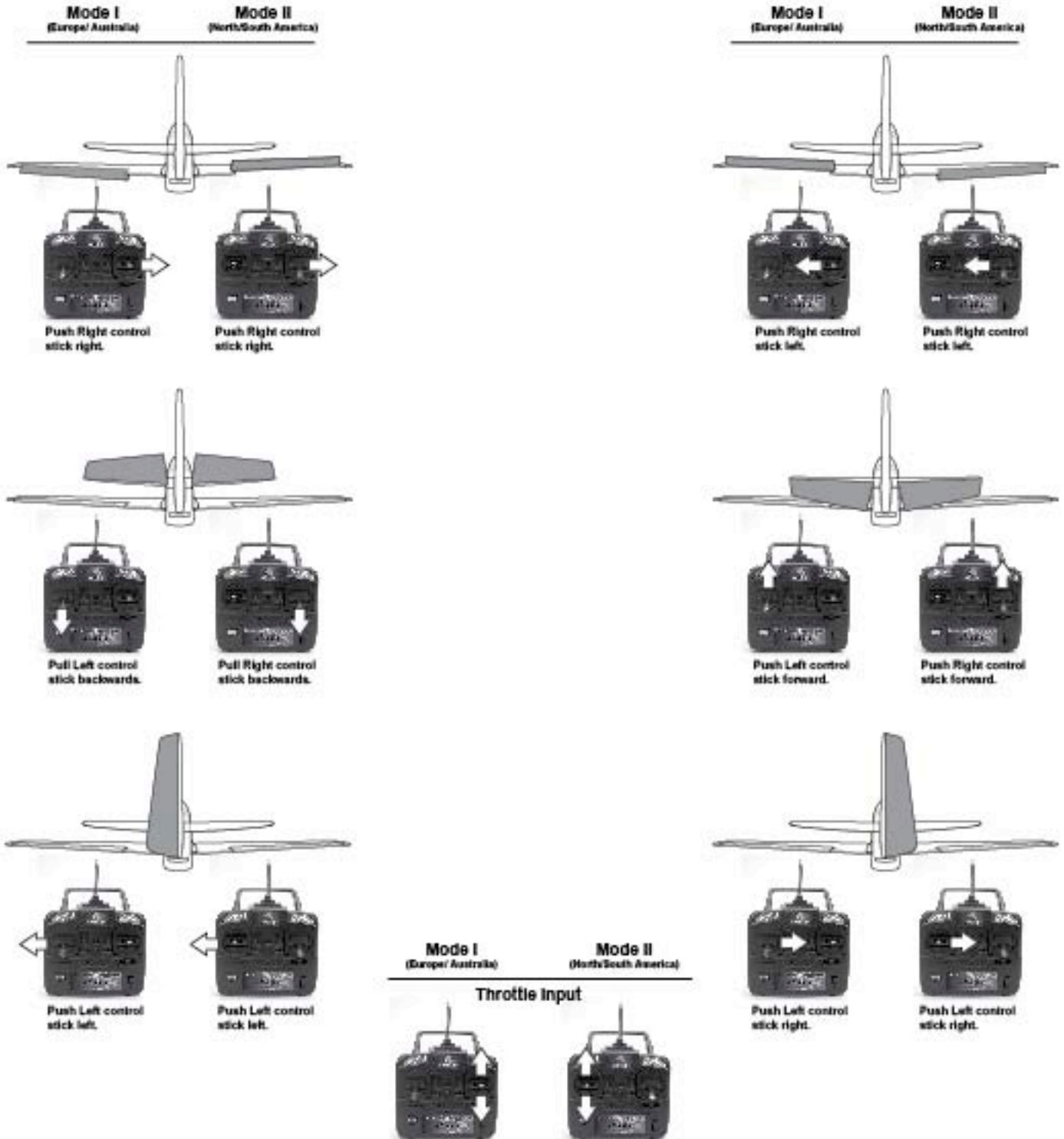



VII. FLIGHT

← Wind Direction

TAKE OFF

- 1) Apply full throttle and take off into the wind.
- 2) Use the tail steering to keep the plane tracking correctly during takeoff.
- 3) When takeoff speed is reached, gently pull back on the elevator to get the model off the ground.
- 4) Once airborne, use the trim sliders to adjust the surfaces until straight level flight is achieved.



Adjusting the Trim

1. If the plane pitches up or down and will not fly level, use the elevator slider to adjust the elevator trim so the plane flies level.



Adjusting the Trim

2. If the model rolls left or right or will not track straight, adjust the aileron and rudder trims so the plane flies straight and level.

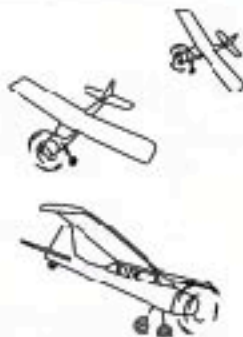

← Wind Direction

LANDING

- 1) Gradually reduce the throttle to slow the model down .
- 2) Add a little up elevator to keep the nose up and allow a gradual decent. Do not apply too much up elevator otherwise the model may stall.
- 3) As the model approaches the ground, cut the throttle and apply a little more up elevator to help it nose-up and touch-down.



VIII. WHERE TO FLY

Fly in an area that is open and free of obstacles and large trees.

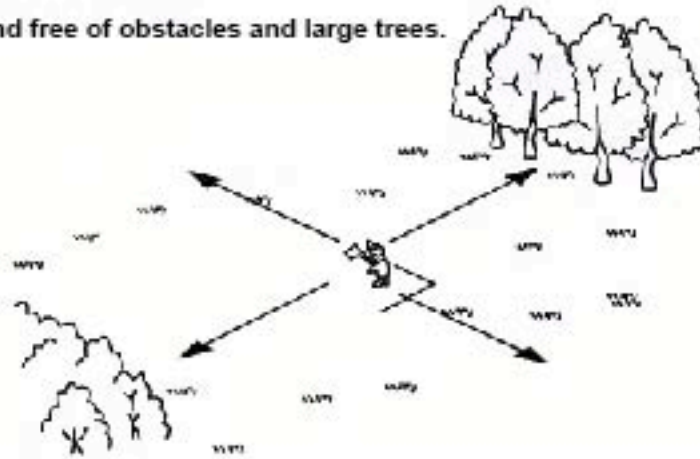

Never fly near roads, people, power lines or residential areas.



The best wind speed for flight is 0-2m/s. As a visual reference, the flag at the flying field or the flag on the transmitter antenna will be below a 45 degree angle.



0 m/s (windless)

YES



1-2 m/s

YES



5m/s above

NO!

Important Notes!

- 1) To avoid accidents, make sure there are no other models nearby using the same transmitter frequencies.
- 2) Never alter the length of the antenna! Shortening the antenna may reduce the range of the transmitter.
- 3) Always keep the transmitter antenna fully extended during use.
- 4) Always turn the transmitter on first and off last to avoid an out of control model.

Island Hopper

INSTRUCTION MANUAL



4Ch Receiver Pot Designations



Tx Switch Positions



Switch Positions



1. In the event of a crash or if you need to remove the Receiver from the model, use this illustration and the list below to correctly reconnect the servos.

Pot 1 = Rudder Pot 1 = Aileron
 Pot 2 = Throttle Pot 2 = Elevator

NOTES

PARTS LIST

PART #	DESCRIPTION	PART #	DESCRIPTION
VENF-6048	Island Hopper 3CH Park Flyer	VENF-6611	Fuse - combo
VENF-6107	Island Hopper Plus 4CH Park Flyer	VENF-6612	Motor 370 - combo
VENF-6600	Main Wing 3CH - Island Hopper	VENF-6613	Battery NiMH 650mah - combo
VENF-6601	Gear Box B 3CH - Island Hopper	VENF-6614	Transmitter - combo
VENF-6602	ESC/Receiver 3CH - Island Hopper	VENF-6615	Charger - combo
VENF-6603	Servo - Island Hopper	VENF-7142	Main Wing 4CH - Island Hopper Plus
VENF-6604	Prop Small - Island Hopper	VENF-7143	Gear Box A 4CH - Island Hopper Plus
VENF-6605	Prop Large - Island Hopper	VENF-7144	ESC 4CH - Island Hopper Plus
VENF-6606	Tail Set Rud/EI - combo	VENF-7145	Receiver 4CH - Island Hopper Plus
VENF-6607	Cowl - combo	VENF-7146	Servo 4CH - Island Hopper Plus
VENF-6608	Nose Cone - combo	VENF-7147	Prop Small - Island Hopper Plus
VENF-6609	Landing Gear - combo	VENF-7148	Prop Large - Island Hopper Plus
VENF-6610	Connecting Arms - combo		

Island Hopper

INSTRUCTION MANUAL



GUARANTEE, NOTICE OF RIGHTS, AND NOTICE OF LIABILITY TEXT

GUARANTEE:

We guarantee the Venom Island Hopper™ to be free of manufacturing faults and material defects. This product has been checked and adjusted individually before leaving the manufacturer. Please contact your local hobby shop for replacement parts and technical support or contact Venom™ Customer Service at 800.705.0620 or customerservice@venom-group.com.

Copyright © 2009 by Venom™

Notice of Rights

All rights reserved. No part of this manual may be reproduced or transmitted in any form by any means, electronic, mechanical, photocopying, recording, or otherwise, without the prior written permission of Venom™. For information on getting permission for reprints and excerpts, contact customerservice@venom-group.com.

Notice of Liability

The information in this manual is distributed on an "As Is" basis, without warranty. While every precaution has been taken in the preparation of the manual Venom™ does not have any liability to any person or entity with respect to any loss or damage caused or alleged to be caused directly or indirectly by the information contained in this manual or by the products described in it.

Venom Group International

14028 N. Ohio Street
Rathdrum Idaho 83858

Australia

PO Box 7325
Alexandria NSW 2015

Customer Service

800.705.0620
customerservice@venom-group.com

WARNINGS & CAUTIONS

Adult supervision is required when using this product. This product should be assembled by an adult before use. Proper assembly should be checked by an adult before use. This product should be periodically examined by an adult for potential hazards. Any potential hazardous parts should be repaired or replaced.

This product contains chemicals known to the State of California to cause Cancer, Birth Defects and other Reproductive Harm. Be responsible, dispose of properly.

DO NOT MIX OLD AND NEW BATTERIES.

DO NOT MIX ALKALINE, STANDARD, OR RECHARGEABLE (NICKLE METAL HYDRIDE BATTERIES).

WARNING: This product may contain sharp edges or objects that can cause cuts or other bodily injury. To prevent cuts or other bodily injury, do not contact sharp edges or objects.

FCC INFORMATION

Compliance with FCC regulations (Valid in U.S. only) This device complies with part 15 FCC rules. Operation of this device is subject to the following two conditions:

1. This device may not cause harmful interference.
2. This device must accept any harmful interference that may cause undesired operation.

This device generates and uses radio frequency energy and if not used properly may cause interference to radio and television reception. It has been tested and found to comply with the limits set by the FCC which are designed to provide reasonable protection against such interference.

FCC Warning:

CAUTION: Venom™ is not responsible for any radio or TV interference caused by unauthorized modifications to this product. Changes or modifications not authorized by Venom™ will void all warranties.

NOTE: This product has been tested and found to comply with the limits for a Class B digital device, compliant to Part 15 of the FCC Rules. These limits are designed to provide reasonable protection against harmful interference in a residential installation. This product generates, uses and can radiate radio frequency energy and, if not installed and used as instructed, may cause harmful interference to radio communications. However, there is no guarantee that interference will not occur in a particular installation. If this product does cause harmful interference to radio or television reception, which can be determined by turning the product on and off, correct the interference by trying one or more of the following measures:

- Reorient or relocate the receiving antenna.
- Increase the separation between the equipment and receiver.
- Connect the equipment into an outlet on a circuit different from the receiver.
- Consult the dealer or an experienced radio/TV technician for help.

LIMITED WARRANTY

Venom™ Limited Warranty

Venom™ warrants this product to be free of material and workmanship defects when new. If a component is defective or was not correctly made, Venom™ will, at its sole discretion, repair or replace it free of charge within 90 days from date of purchase. If you believe a defect became evident only after operation, please contact us to discuss your warranty claim.

A dated & itemized sales receipt must accompany any product returned for warranty work. Before returning any product, please contact Venom™ Customer Service at 800-705-0620 to receive a Return Merchandise Authorization Number (RMA#).



Venom Group International
14028 N. Ohio Street
Rathdrum, Idaho 83858

Australia
PO Box 7325
Alexandria NSW 2015

Customer Service
800.705.0620
customerservice@venom-group.com